

Replacement Parts

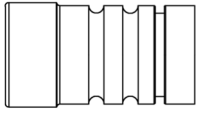

PART 1
Straight Swivel Nipple

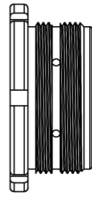

PART 2
Holding Nut

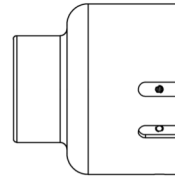

PART 3
Straight One Swivel Body

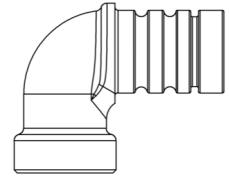

PART 4
EII Swivel Nipple

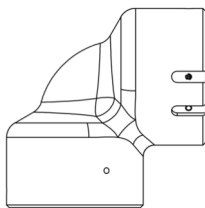

PART 5
EII Two Swivel Body

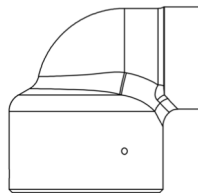

PART 6
EII One Swivel Body

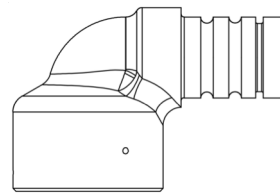

PART 7
EII Two Swivel Nipple

ACCESSORIES

- Ball Bearings
- Lock Bar
- O-Ring
- V-Ring Adapters (upper, lower)

SERVICING

1. TM Swivel Joints are greased at the factory and require only occasional lubrication, unless joint is in constant rotation or high temperature service.
 - When lubricating, remove slotted plug on outside of rotating element, insert alemite fitting, and lubricate until grease fills ball races and extrudes through weep hole.
2. Provisions have been made for take-up on packing to compensate for packing wear. If joint leaks, remove lock bar, turn nut clockwise to next locking slot, and reinstall lock bar. This process may be repeated until packing has been worn too badly to affect seal.
3. When using Teflon packing, take-up on packing when joint has been in service no longer than two weeks to compensate for packing set.

REPACKING INSTRUCTIONS

1. Remove lock bar.
2. Remove nut and nipple assembly from body by turning nut counter clockwise.
3. Remove back up ring from body.
4. Remove two chevron packing rings.
5. Remove male adapter.
6. Clean packing chamber, grease all parts thoroughly, and reinstall (a) male adapter (b) new chevron packing rings, and (c) back up ring.
7. Insert nut and nipple assembly in body and tighten. Rotate nipple as the nipple passes through the packing.
8. Screw nut clockwise until compression on packing causes nipple to rotate with increased torque. Reinstall lock bar.
9. **NOTE: You don't need to handle the balls or disassemble the nut and nipple to change chevron packing in TM Swivel Joints!**