

Styles

STYLE 100
Straight Single Swivel

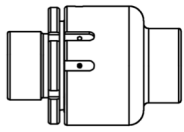

STYLE 200
One-Ell Single Swivel

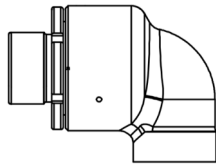
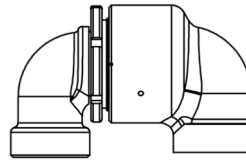

STYLE 300
Two-Ell Single Swivel

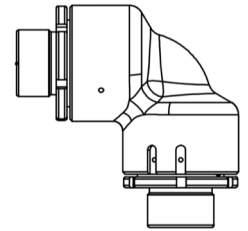

STYLE 400
One-Ell Double Swivel

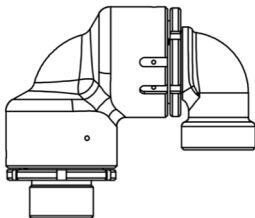

STYLE 500
Two-Ell Double Swivel

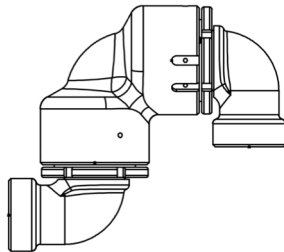

STYLE 600
Three-Ell Double Swivel

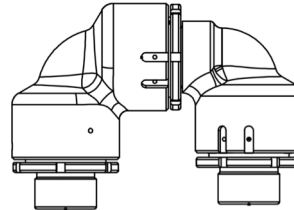

STYLE 700
Two-Ell Triple Swivel

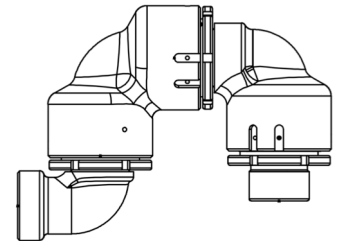

STYLE 800
Three-Ell Triple Swivel

MATERIALS

125 PSI Aluminum Alloy
Color Code: Aluminum

1000 PSI Steel
Color Code: Blue

6000 PSI Steel
Color Code: Red

15,000 PSI Steel
Color Code: Yellow

125 PSI Type 316 Stainless Steel
Color Code as Cast

Special Alloys
Color Code by Type

PSI = Maximum Working Pressure (cold)

TEMPERATURES

225°F Buna-N Packing
500°F Aramid Fiber
300°F Teflon
400°F Viton

SIZES

$\frac{3}{8}$ " — 24" Pipe Size
Larger on Request

SPECIAL ORDERS

We can provide customized solutions to meet your needs,
manufactured on order.

**STANDARD
END CONNECTIONS**

Threaded Ends (TE) (Female NPT)
Beveled for Weld (BV) (Beveled)
Bored for Weld (BR) (Bored)
Flanged
Special on Request