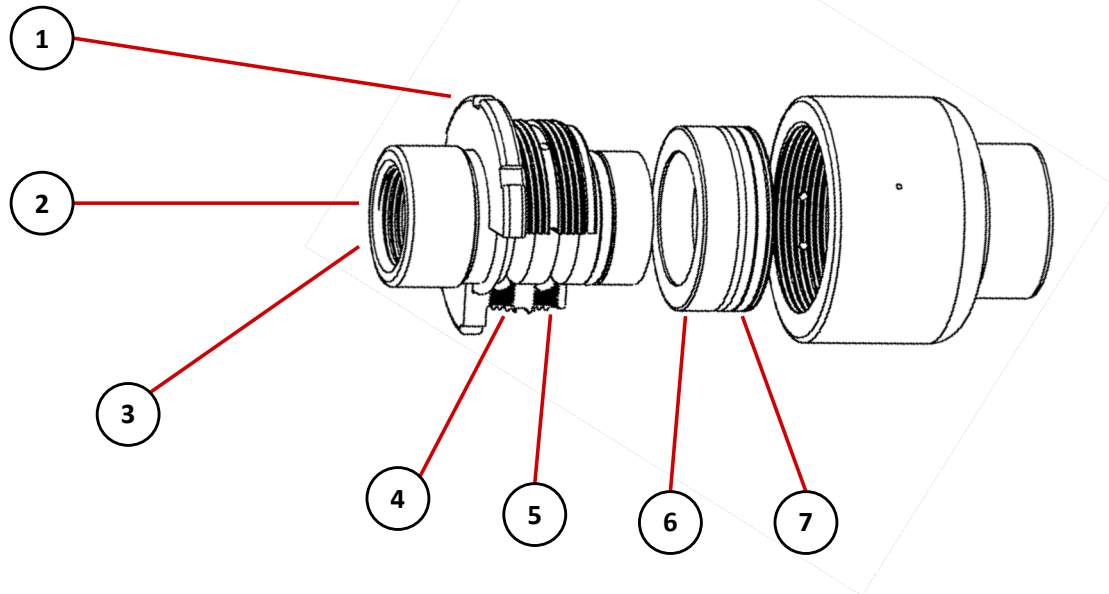

The Original

- 1 PACKING TAKE-UP**
Tightening the packing nut will compress our special two-chevron design packing, extending the packing life.
- 2 COMPLETE UNION ASSEMBLY**
Repack anywhere, anytime, without handling ball bearings, even when the joint is welded into the line. Reduces service and maintenance to an absolute minimum.
- 3 NO-LEAK PERFORMANCE**
Superior engineering design enables guaranteed, no-leak performance for most applications.
- 4 SEALED BALL BEARING UNIT**
Factory-assembled rotating unit is sealed from outside contaminants and line fluids by “o” rings. Lubricants are sealed in, and foreign matter sealed out. The quality design reduced maintenance costs by eliminating the need for daily lubrication, while extending the life of the swivel joint.
- 5 QUALITY BEARING DESIGN**
The finest alloy steels are used in TM Swivel Joints. Hardened ball races in our 6,000 psi and 15,000 psi steel swivel joints, coupled with hardened chrome alloy steel ball bearings, assure longer life and fewer replacements.
- 6 RUGGED OUTBOARD BEARING**
The packing backup ring acts as a solid bearing during severe or shock loads. This protects the ball races from brinelling, and eliminates misalignment leaks, guaranteeing top performance under varied conditions.
- 7 STANDARD PACKING THROUGHOUT**
Packing for all applications available in standard sizes and materials.